

KEY BENEFITS

- Fire safe API 607 design
- ISO 5211 mounting pad
- NACE MR-0175 compliant



TWO-PIECE CLASS 1500 FULL PORT THREADED BALL VALVE

OVERVIEW

The Apache CFT3M Series is a two-piece Class 1500 full-port threaded ball valve for industrial and commercial applications. This series features cast steel body construction, floating ball design, fire safe API 607 compliance, ISO 5211 mounting pad, blow-out proof stem, locking handle, and NACE MR-0175 compliance.

DIMENSIONAL DATA

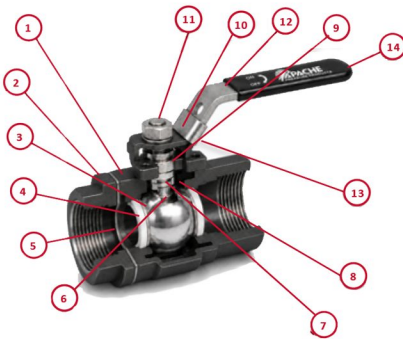

SKU	NPT	A	B	C	D
CFT3M0250F	1/4"	0.25	3.00	2.22	5.00
CFT3M0500F	1/2"	0.50	4.00	2.22	5.00
CFT3M0750F	3/4"	0.75	4.30	2.89	5.83
CFT3M1000F	1"	1.00	4.80	3.50	8.19
CFT3M1500F	1-1/2"	1.50	5.30	4.34	10.16

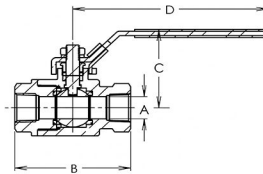

NOTE:
Dimensions in inches. Source part numbers shown as SKU.

PRESSURE / TEMPERATURE RATING

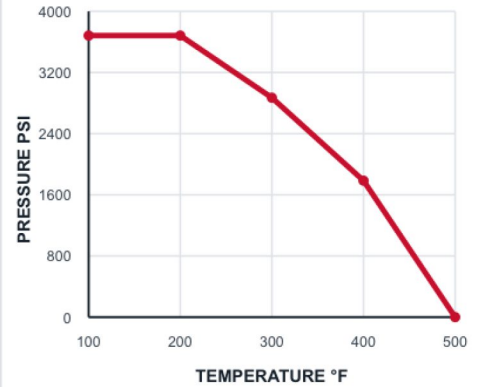

MATERIALS / CONSTRUCTION

#	COMPONENT	MATERIAL / SPECIFICATION
1	Body	WCB
2	Cap	WCB
3	Ball	CF8M
4	Seat	DELTRIN
5	Joint Gasket	GRAPHITE
6	Stem	SS316 OR 17-4 (1-1/2", 2")
7	Thrust Washer	DELTRIN
8	Stem Packing	GRAPHITE
9	Gland Nut	AISI 304
10	Spring Washer	AISI 304
11	Stem Nut	AISI 304
12	Handle	AISI 304
13	Locking Device	AISI 304
14	Handle Sleeve	PVC

STANDARDS & OPTIONS

Pressure Rating	ASME B16.34 Class 1500, 3705 WOG
Body	Cast steel body, floating ball
Port	Full port
Valve Style	Two-piece threaded ball valve
Fire Safe	API 607
Stem	Blow-out proof stem
Mounting	ISO 5211 mounting pad
Handle	Locking handle
Threads	ANSI B1.20.1, BS21, DIN 259/2999
Compliance	NACE MR-0175 compliant

QUALITY. INTEGRITY. RELIABILITY.

Engineered solutions for demanding environments.

www.apachemfg.com

GREATER HOUSTON

8809 Bailey Rd
Manvel, TX 77578
(713) 941-1669

ODESSA

2650 West Remington Rd
Odessa, TX 79763
(432) 385-7470