



CV-150 SERIES

CLASS 150 FLANGED SWING CHECK VALVE

KEY BENEFITS

- ANSI Class 150 · swing check
- A216 WCB body · CF8M disc & hinge
- Bolted bonnet · Viton seat · 2"-8"



CLASS 150 FLANGED SWING CHECK VALVE

OVERVIEW

The Apache CV-150 Series is a Class 150 flanged swing check valve in ASTM A216 WCB cast steel. A bolted bonnet, CF8M stainless-faced disc and hinge, and Viton seat deliver reliable non-return service for pipeline and process lines in 2" through 8" sizes.

DIMENSIONAL DATA

NPS	L	D	H	D	D1	D2	N-Ø	F	T(MIN)	WT (LB)
2"	7.99	1.97	5.55	5.91	4.75	3.63	4 × Ø0.75	0.08	0.64	27
3"	9.49	2.99	6.89	7.48	6.00	5.00	4 × Ø0.75	0.08	0.77	50
4"	11.50	4.02	7.72	9.06	7.50	6.19	8 × Ø0.75	0.08	0.96	82
6"	14.02	5.98	9.92	11.02	9.50	8.50	8 × Ø0.87	0.08	1.02	133
8"	19.49	7.91	11.36	13.50	11.75	10.63	8 × Ø0.87	0.08	1.14	237

Dimensions in inches; weights in lb. L = face-to-face · d = bore · H = overall height · D = flange OD · D1 = bolt circle · D2 = raised-face OD · n-Ø = bolt count × hole dia · f = raised-face height · T(Min) = minimum wall thickness. Flanges per ASME B16.5 Class 150.

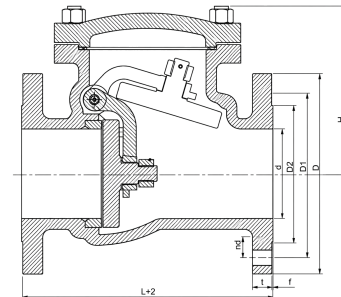
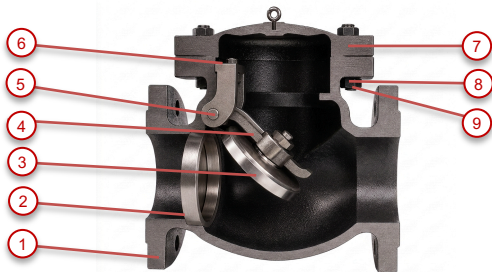

STANDARDS & OPTIONS

Pressure Rating	ANSI Class 150
Design	Flanged swing check valve
Body / Bonnet	ASTM A216 WCB (bolted bonnet)
Disc	ASTM A216-WCB + CF8M
Seat	Viton
End Connections	ANSI Class 150 flanged (raised face)
Sizes	2", 3", 4", 6", 8"

MATERIALS / CONSTRUCTION

#	COMPONENT	MATERIAL
1	Body	ASTM A216 WCB
2	Seat	Viton
3	Disc	ASTM A216-WCB + CF8M
4	Hinge	CF8M
5	Hinge Pin	ASTM A276 420
6	Gasket	FLEX Graphite / 316
7	Bonnet	ASTM A216 WCB
8	Bonnet Bolt Nut	ASTM A194 Gr. 2H
9	Bonnet Bolt	ASTM A193 Gr. B7

QUALITY. INTEGRITY. RELIABILITY.

Engineered solutions for demanding environments.

www.apachemfg.com

GREATER HOUSTON

8809 Bailey Rd
Manvel, TX 77578
(713) 941-1669

ODESSA

2650 West Remington Rd
Odessa, TX 79763
(432) 385-7470