



FIG 1502 SERIES

15000 PSI HIGH-PRESSURE HAMMER UNION

KEY BENEFITS

- 15,000 PSI NSCWP · WOG service up to 15,000 PSI
- Lip-type seal ring for reduced turbulence
- NPT threaded or XXH buttweid · 2" through 4"



15000 PSI NSCWP HIGH-PRESSURE HAMMER UNION

OVERVIEW

The Apache FIG 1502 is a high-pressure hammer union rated 15,000 PSI non-shock cold working pressure for water, oil, and gas service. A lip-type seal ring reduces turbulence across the joint. Available with NPT threaded or extra-extra-heavy buttweid ends in 2" through 4" sizes.

DIMENSIONAL DATA

PART #	CONN.	A (IN)	B (IN)	M SUB	F SUB	NUT	WT (LB)
A1502T-2.0	2" THD	3.88	7.00	4130	4130	4130	18.50
A1502B160-2.0	2" XXH BW	3.88	6.75	4130	4130	4130	19.50
A1502T-3.0	3" THD	4.50	5.50	4130	4130	4140	25.00
A1502B160-3.0	3" XXH BW	4.50	5.50	4130	4130	4140	28.00
A1502T-4.0	4" THD	5.63	9.50	4130	4130	4140	61.00
A1502B160-4.0	4" XXH BW	5.63	9.50	4130	4130	4140	77.25

Dimensions in inches; weights in lb. A and B per the dimensional drawing. Conn.: THD = NPT threaded · XXH BW = extra-extra-heavy buttweid. Materials are AISI alloy steel (4130 / 4140). NSCWP 15,000 PSI · test pressure 22,500 PSI. Lip-type seal ring.

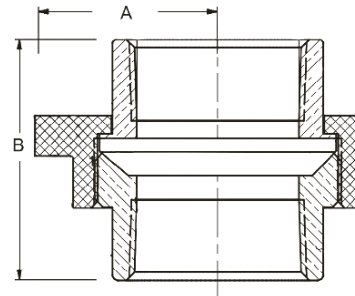

STANDARDS & OPTIONS

Pressure Rating	15,000 PSI NSCWP · WOG up to 15,000 PSI
Test Pressure	22,500 PSI
Design	High-pressure hammer union
Sealing	Lip-type seal ring (reduced turbulence)
End Connections	NPT threaded · XXH buttweid
Sizes	2", 3", 4"
Service	Standard service – not suitable for sour gas

MATERIALS / CONSTRUCTION

#	COMPONENT	MATERIAL
1	Male Sub	AISI 4130 alloy steel
2	Female Sub	AISI 4130 alloy steel
3	Wing Nut	AISI 4130 / 4140
4	Seal Ring	Lip-type seal ring

PRODUCT WARNINGS

Pressure-containing piping components are dangerous if used incorrectly. Observe all industry safety standards and common sense when working around any pressure-containing equipment. Failure to do so can result in serious bodily injury or death.

- **DO NOT** exceed the recommended working pressure rating.
- **DO NOT** mix and match components of different pressure ratings. Mismatched unions can fail explosively, resulting in property damage, injury, or death.
- **DO NOT** strike a hammer union that is under pressure.
- **DO NOT** use a union that is worn, damaged, or deteriorated in any way.
- **DO NOT** mix standard and sour-gas service products. Standard service equipment is not suitable for sour applications.
- **DO NOT** use Apache products in overhead suspension applications.
- Make sure the piping system is depressurized when disassembling union connections.
- Properly identify the figure number and pressure rating when selecting a union for service.
- Take extra care when working in ambient temperatures below freezing. Low temperature reduces the ductility and impact strength of iron and steel.
- Wear appropriate protective equipment when installing and disassembling Apache products.
- Remove leaking components immediately.
- Remove from service and dispose of any equipment where positive identification of the product's size, figure, and pressure rating is not possible due to deterioration or other damage.

QUALITY. INTEGRITY. RELIABILITY.

Engineered solutions for demanding environments.

www.apachemfg.com

GREATER HOUSTON

8809 Bailey Rd
Manvel, TX 77578
(713) 941-1669

ODESSA

2650 West Remington Rd
Odessa, TX 79763
(432) 385-7470