



FIG 200 SERIES

2000 PSI GENERAL PURPOSE HAMMER UNION

KEY BENEFITS

- 2,000 PSI NSCWP · WOG service up to 2,000 PSI
- NPT threaded connections · 1" through 8"
- FIG 206 supplied with Buna O-ring for improved sealing



2000 PSI NSCWP GENERAL PURPOSE HAMMER UNION

OVERVIEW

The Apache FIG 200 is a general-purpose hammer union rated 2,000 PSI non-shock cold working pressure for water, oil, and gas service. NPT threaded male and female subs make up quickly with a hammer-tight wing nut, in sizes 1" through 8". The FIG 206 is supplied with a Buna O-ring for improved sealing.

DIMENSIONAL DATA

PART #	NPT	A (IN)	B (IN)	M SUB	F SUB	NUT	WT (LB)
A200T-1.0	1"	1.97	2.89	A105	A105	CS	1.75
A200T-1.5	1-1/2"	2.38	2.85	CS	CS	CS	2.37
A200T-2.0	2"	2.95	3.66	A105	A105	CS	5.75
A200T-2.5	2-1/2"	3.74	4.21	CS	CS	CS	10.00
A200T-3.0	3"	3.96	5.04	A105	A105	CS	15.25
A200T-4.0	4"	4.55	4.92	CS	CS	CS	20.00
A200T-6.0	6"	6.57	7.48	DI	DI	DI	48.00
A200T-8.0	8"	8.50	8.72	DI	DI	DI	59.00

Dimensions in inches; weights in lb. A and B per the dimensional drawing. M Sub / F Sub / Nut columns list material by size: A105 = ASTM A105 forged steel · CS = carbon steel · DI = ductile iron. NSCWP 2,000 PSI · test pressure 3,000 PSI.

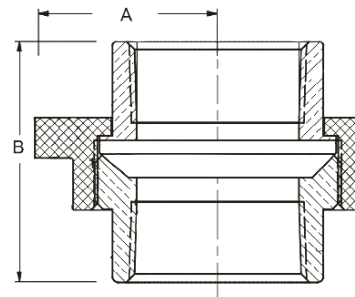

STANDARDS & OPTIONS

Pressure Rating	2,000 PSI NSCWP · WOG up to 2,000 PSI
Test Pressure	3,000 PSI
Design	General purpose hammer union
End Connections	NPT threaded
Sizes	1", 1-1/2", 2", 2-1/2", 3", 4", 6", 8"
Sealing	Metal-to-metal; FIG 206 adds Buna O-ring
Service	Standard service — not suitable for sour gas

MATERIALS / CONSTRUCTION

#	COMPONENT	MATERIAL
1	Male Sub	ASTM A105 / carbon steel (DI on 6"-8")
2	Female Sub	ASTM A105 / carbon steel (DI on 6"-8")
3	Wing Nut	Carbon steel (DI on 6"-8")
4	O-Ring (FIG 206)	Buna-N

PRODUCT WARNINGS

Pressure-containing piping components are dangerous if used incorrectly. Observe all industry safety standards and common sense when working around any pressure-containing equipment. Failure to do so can result in serious bodily injury or death.

- **DO NOT** exceed the recommended working pressure rating.
- **DO NOT** mix and match components of different pressure ratings. Mismatched unions can fail explosively, resulting in property damage, injury, or death.
- **DO NOT** strike a hammer union that is under pressure.
- **DO NOT** use a union that is worn, damaged, or deteriorated in any way.
- **DO NOT** mix standard and sour-gas service products. Standard service equipment is not suitable for sour applications.
- **DO NOT** use Apache products in overhead suspension applications.
- Make sure the piping system is depressurized when disassembling union connections.
- Properly identify the figure number and pressure rating when selecting a union for service.
- Take extra care when working in ambient temperatures below freezing. Low temperature reduces the ductility and impact strength of iron and steel.
- Wear appropriate protective equipment when installing and disassembling Apache products.
- Remove leaking components immediately.
- Remove from service and dispose of any equipment where positive identification of the product's size, figure, and pressure rating is not possible due to deterioration or other damage.

QUALITY. INTEGRITY. RELIABILITY.

Engineered solutions for demanding environments.

www.apachemfg.com

GREATER HOUSTON

8809 Bailey Rd
Manvel, TX 77578
(713) 941-1669

ODESSA

2650 West Remington Rd
Odessa, TX 79763
(432) 385-7470