



# FIG 300 SERIES

## 2000 PSI FLAT-FACE HAMMER UNION

### KEY BENEFITS

- 2,000 PSI NSCWP · WOG service up to 2,000 PSI
- Flat-face design for a straight break-out
- Supplied with a Buna-N O-ring seal · NPT threaded



## 2000 PSI NSCWP FLAT-FACE HAMMER UNION

### OVERVIEW

The Apache FIG 300 is a flat-face hammer union rated 2,000 PSI non-shock cold working pressure for water, oil, and gas service. The flat-face design allows a straight break-out and is supplied with a Buna-N O-ring seal. NPT threaded male and female subs make up with a hammer-tight wing nut, in 1" and 2" sizes.

### DIMENSIONAL DATA

PART #	NPT	A (IN)	B (IN)	M SUB	F SUB	NUT	WT (LB)
A300T-1.0	1"	1.94	2.69	A105	A105	CS	1.75
A300T-2.0	2"	2.89	3.88	A105	A105	CS	5.25

Dimensions in inches; weights in lb. A and B per the dimensional drawing. Material columns list M Sub / F Sub / Nut: A105 = ASTM A105 forged steel · CS = carbon steel. NSCWP 2,000 PSI · test pressure 3,000 PSI. Flat-face design with Buna-N O-ring seal for straight break-out.

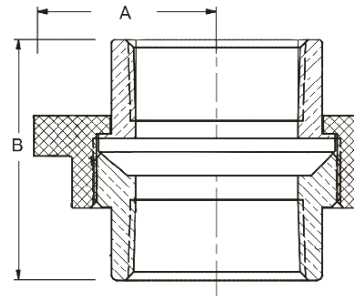

### STANDARDS & OPTIONS

Pressure Rating	2,000 PSI NSCWP · WOG up to 2,000 PSI
Test Pressure	3,000 PSI
Design	Flat-face union (straight break-out)
Sealing	Buna-N O-ring (flat face)
End Connections	NPT threaded
Sizes	1", 2"
Service	Standard service – not suitable for sour gas

### MATERIALS / CONSTRUCTION

#	COMPONENT	MATERIAL
1	Male Sub	ASTM A105
2	Female Sub	ASTM A105
3	Wing Nut	Carbon steel
4	O-Ring	Buna-N (flat-face seal)

### PRODUCT WARNINGS

Pressure-containing piping components are dangerous if used incorrectly. Observe all industry safety standards and common sense when working around any pressure-containing equipment. Failure to do so can result in serious bodily injury or death.

- **DO NOT** exceed the recommended working pressure rating.
- **DO NOT** mix and match components of different pressure ratings. Mismatched unions can fail explosively, resulting in property damage, injury, or death.
- **DO NOT** strike a hammer union that is under pressure.
- **DO NOT** use a union that is worn, damaged, or deteriorated in any way.
- **DO NOT** mix standard and sour-gas service products. Standard service equipment is not suitable for sour applications.
- **DO NOT** use Apache products in overhead suspension applications.
- Make sure the piping system is depressurized when disassembling union connections.
- Properly identify the figure number and pressure rating when selecting a union for service.
- Take extra care when working in ambient temperatures below freezing. Low temperature reduces the ductility and impact strength of iron and steel.
- Wear appropriate protective equipment when installing and disassembling Apache products.
- Remove leaking components immediately.
- Remove from service and dispose of any equipment where positive identification of the product's size, figure, and pressure rating is not possible due to deterioration or other damage.

## QUALITY. INTEGRITY. RELIABILITY.

Engineered solutions for demanding environments.

[www.apachemfg.com](http://www.apachemfg.com)

### GREATER HOUSTON

8809 Bailey Rd  
Manvel, TX 77578  
(713) 941-1669

### ODESSA

2650 West Remington Rd  
Odessa, TX 79763  
(432) 385-7470