



# FIG 602 SERIES

6000 PSI ALLOY STEEL HAMMER UNION

## KEY BENEFITS

- 6,000 PSI NSCWP · WOG service up to 6,000 PSI
- Alloy steel · lip-type seal ring for reduced turbulence
- NPT threaded or XXH buttweld · API 7HU1 design available



## 6000 PSI NSCWP ALLOY STEEL HAMMER UNION

### OVERVIEW

The Apache FIG 602 is an alloy steel hammer union rated 6,000 PSI non-shock cold working pressure for water, oil, and gas service. A lip-type seal ring reduces turbulence across the joint. Available with NPT threaded or extra-extra-heavy buttweld ends in 1" through 4" sizes, including an API 7HU1-compliant variant.

### DIMENSIONAL DATA

PART #	CONN.	A (IN)	B (IN)	M SUB	F SUB	NUT	WT (LB)
A602T-1.0	1" THD	2.42	3.62	4130	4130	4130	3.50
A602T-2.0	2" THD	3.56	5.25	4130	4130	4130	13.25
A602T-2.07HU1	2" THD	3.66	5.83	4130	4130	4130	15.25
A602B160-2.0	2" XXH BW	3.54	5.39	4130	4130	4140	14.50
A602T-3.0	3" THD	4.63	6.37	4130	4130	4130	21.00
A602B160-3.0	3" XXH BW	4.37	5.78	4130	4130	4140	22.00
A602T-4.0	4" THD	5.25	8.19	4130	4130	4140	33.00
A602B160-4.0	4" XXH BW	5.20	6.10	4130	4130	4140	38.50

Dimensions in inches; weights in lb. A and B per the dimensional drawing. Conn.: THD = NPT threaded · XXH BW = extra-extra-heavy buttweld. Materials are AISI alloy steel (4130 / 4140). A602T-2.07HU1 is the API 7HU1-compliant variant. NSCWP 6,000 PSI · test pressure 9,000 PSI. Lip-type seal ring.

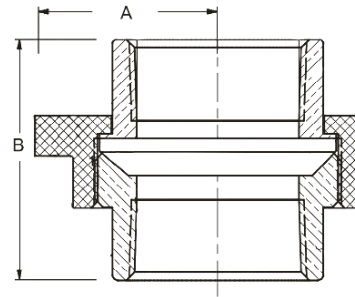

### STANDARDS & OPTIONS

Pressure Rating	6,000 PSI NSCWP · WOG up to 6,000 PSI
Test Pressure	9,000 PSI
Design	Alloy steel hammer union (API 7HU1 available)
Sealing	Lip-type seal ring (reduced turbulence)
End Connections	NPT threaded · XXH buttweld
Sizes	1", 2", 3", 4"
Service	Standard service — not suitable for sour gas

### MATERIALS / CONSTRUCTION

#	COMPONENT	MATERIAL
1	Male Sub	AISI 4130 alloy steel
2	Female Sub	AISI 4130 alloy steel
3	Wing Nut	AISI 4130 / 4140
4	Seal Ring	Lip-type seal ring

### PRODUCT WARNINGS

Pressure-containing piping components are dangerous if used incorrectly. Observe all industry safety standards and common sense when working around any pressure-containing equipment. Failure to do so can result in serious bodily injury or death.

- **DO NOT** exceed the recommended working pressure rating.
- **DO NOT** mix and match components of different pressure ratings. Mismatched unions can fail explosively, resulting in property damage, injury, or death.
- **DO NOT** strike a hammer union that is under pressure.
- **DO NOT** use a union that is worn, damaged, or deteriorated in any way.
- **DO NOT** mix standard and sour-gas service products. Standard service equipment is not suitable for sour applications.
- **DO NOT** use Apache products in overhead suspension applications.
- Make sure the piping system is depressurized when disassembling union connections.
- Properly identify the figure number and pressure rating when selecting a union for service.
- Take extra care when working in ambient temperatures below freezing. Low temperature reduces the ductility and impact strength of iron and steel.
- Wear appropriate protective equipment when installing and disassembling Apache products.
- Remove leaking components immediately.
- Remove from service and dispose of any equipment where positive identification of the product's size, figure, and pressure rating is not possible due to deterioration or other damage.

## QUALITY. INTEGRITY. RELIABILITY.

Engineered solutions for demanding environments.

[www.apachemfg.com](http://www.apachemfg.com)

### GREATER HOUSTON

8809 Bailey Rd  
Manvel, TX 77578  
(713) 941-1669

### ODESSA

2650 West Remington Rd  
Odessa, TX 79763  
(432) 385-7470